

The king of water purification

New concept: Odorless, spot free and without bags



Soluciones Inteligentes

PLASTER TRAP

OF STAINLESS STEEL



Ref. BM99995

P.V.P

949,- € (+ IVA)



159,- € (+ IVA)

- Thanks to its retaining handel, the 9-liter gypsum separator is easy to open, carry and empty.
- Its intelligent design made of stainless steel allows a tube-free installation directly under the basin drain with right or left drainage.
- The front drainage tap allows drainage of excess water before emptying, thus avoiding spilling while opening.

If the gypsum separator can not be mounted on the wall then this sturdy floor stand made of 40 mm aluminum profiles is available. (Ref. BM99996)

For use in dental laboratories and dentist's office:

Thanks to its compact size, the plaster separator is mounted only once under the basin instead of the siphon. Since the entry of contaminated water into the decanter is below the drain level, the return flow of the stinking air caused by bacteria in stagnant water is blocked. Due to centrifugal forces and a long residence time, the plaster trap separates reliably undissolved suspended solids - such as gypsum - and avoids their sedimentation in the sewage pipes. Other plastic systems are often unsuitable for removing soapy water or avoiding odors.

Simple, clean and fast handling:

After draining excess water through the drain valve on the front, simply lift the handle by hand. Thanks to it, you can easily hold the bucket and empty it quickly, without wasting much working time. Particularly useful is that no consumables (such as bags) or accessories (such as pumps) are needed to empty. In addition, the stainless steel container is easy to clean.

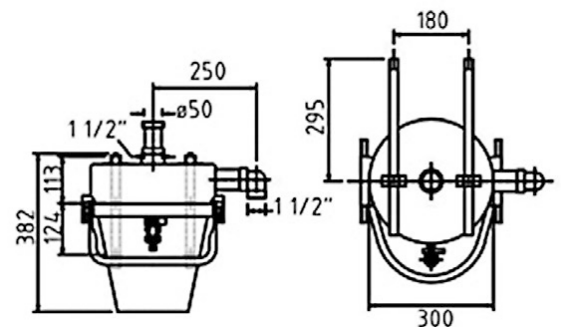

The drainage orientation can be to the right or left side. The connection dimensions are for the inlet 1 1/2" IG and for the outlet 1 1/2" AG. The large bucket volume of 9 liters allows long change intervals.